

# Learning Disability Budget

From March 09 to  
March 10

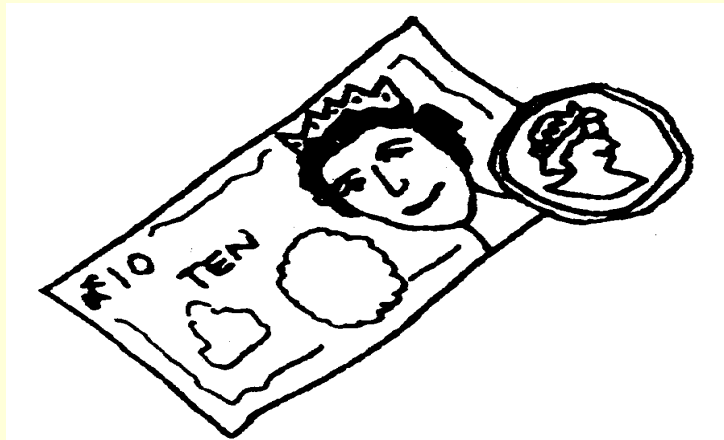

**Diana Bernhardt**

# Today

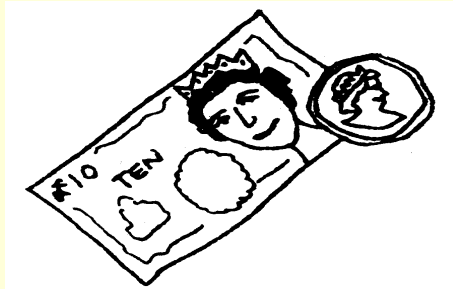

- How much money
- What it is spent on
- What we are doing differently

# How much money

- We will spend £31 million on Learning Disability services
- Plus £1 million Supporting People funding

# What we spend the money on

- Accommodation services

- Day services

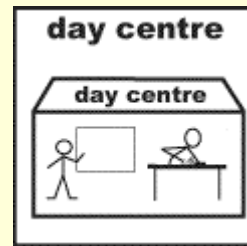

- Support in their own home

- Direct payments

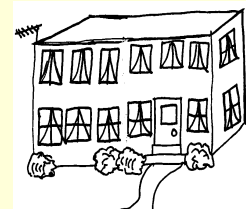

- Social work and health team

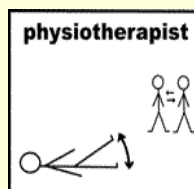
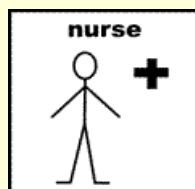
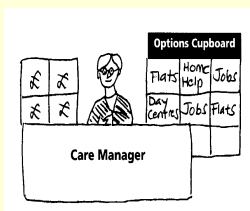

# What we are doing

- Increasing money spent on Direct Payments
- Making sure we are paying the right price for services
- Helping people to move into the right accommodation
- Making sure services are funded correctly
- Increasing number of social workers carrying out reviews